

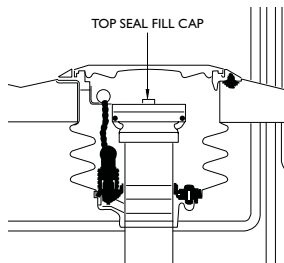

4" TOP SEAL FILL CAP

EBW top seal fill caps are used to prevent vapors from escaping the fill riser pipe on the underground storage tank when it is not being filled. The geometry of the linkage provides self-centering characteristics for dependable sealing. The easy-to-operate T-handle provides a convenient method of removal and replacement — simply pull to remove and push to replace.

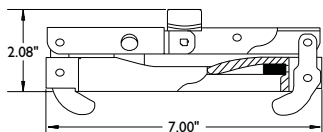

HIGHLIGHTS

- Glass-filled nylon and aluminum body styles available.
- Stainless steel latches.
- Padlock capability.
- Form-fitting replaceable gasket, molds itself to the contour of the adapter to form a positive seal for added protection.

Model	Description	Weight	
		Lbs	Kg
77720102*	CARB EVR glass-filled PBT, AGB	1.00	0.45
77720202	Aluminum, epoxy-coated gray, AGB	1.12	0.51
95021501	CARB approved replacement gasket	0.20	0.90

Model	Description
777201901*	Glass-filled PBT, 20 pack

*Biofuel approved model (E85 and Biodiesel), CARB: Phase 1 Certification VR-101.



3" TOP SEAL FILL CAP

This durable 3" top seal single lever cap provides a tight positive seal on all 3" adapters.

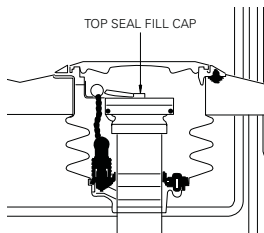
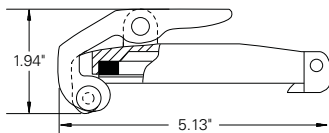

HIGHLIGHTS

- Extruded brass cam arm.
- Cap body made of corrosion-resistant epoxy-coated aluminum.

Model	Description	Weight	
		Lbs	Kg
77920001	3" top seal fill cap	1.00	0.45

Model	Description
77420203	3" replacement gasket

